



## MotoSim<sup>®</sup> TOUCH

### COMPLETE VIRTUAL INDUSTRIAL ROBOTIC SOLUTION FOR STUDENTS

#### KEY BENEFITS

Provides “real world” virtual robotics experience at a fraction of the cost of an industrial robot

Provides hands-on, STEM-aligned environment for robotic modeling and programming

Teaches industry-recognized career ready robotics skills

#### SYSTEM REQUIREMENTS

Recommended	Minimum
Windows® 7 (64 bit)	Windows® 7 (32 bit)
Intel Core i5 CPU	Intel Core 2 Duo CPU
4-8 GB RAM	2 GB RAM
3D Pro graphics card	3D graphics card
4 GB of free hard drive space	

#### CONTROLLERS



DX200



DX100



FS100

- PC-based offline programming environment and robotics simulation tool.
- Designed specifically for K-16 schools, training organizations and educational research institutions.
- Simulates a fully functional production environment.
- Setup in the classroom or robotics lab is quick and easy, with only four cables to plug in.
- Provides the ability for students to toggle between a virtual pendant and a hardware pendant.
- In either mode, students utilize MotoSim EG-VRC\* for Education, a comprehensive offline programming and simulation software package.
- Virtual pendant and hardware pendant both utilize easy-to-use INFORM III programming language.
- Robot programs can be moved from the simulation environment to the classroom robot.
- Learn how to program and model industrial robots in a safe, virtual PC environment:
  - Enter and modify data to create a robot job
  - Perform collision detection, reach analysis and cycle time calculations
  - Perform testing and diagnostics
  - Download robot job to robot controller
- Become proficient with a wide variety of robot functions, including:
  - Robot path
  - Speed
  - TCP (tool center point)
  - User frames
  - I/O monitors
  - Macro command
  - Relative job
  - Enhanced multiple robot control
  - Independent/coordinated motion
  - External axis control and coordination
  - User definable view



**1300 552 333**  
**www.ragroup.com.au**

NOTE: MotoSim Touch is available only to the educational market at this time.

\* MotoSim Enhanced Graphics - Virtual Robot Controller

## MotoSim Touch

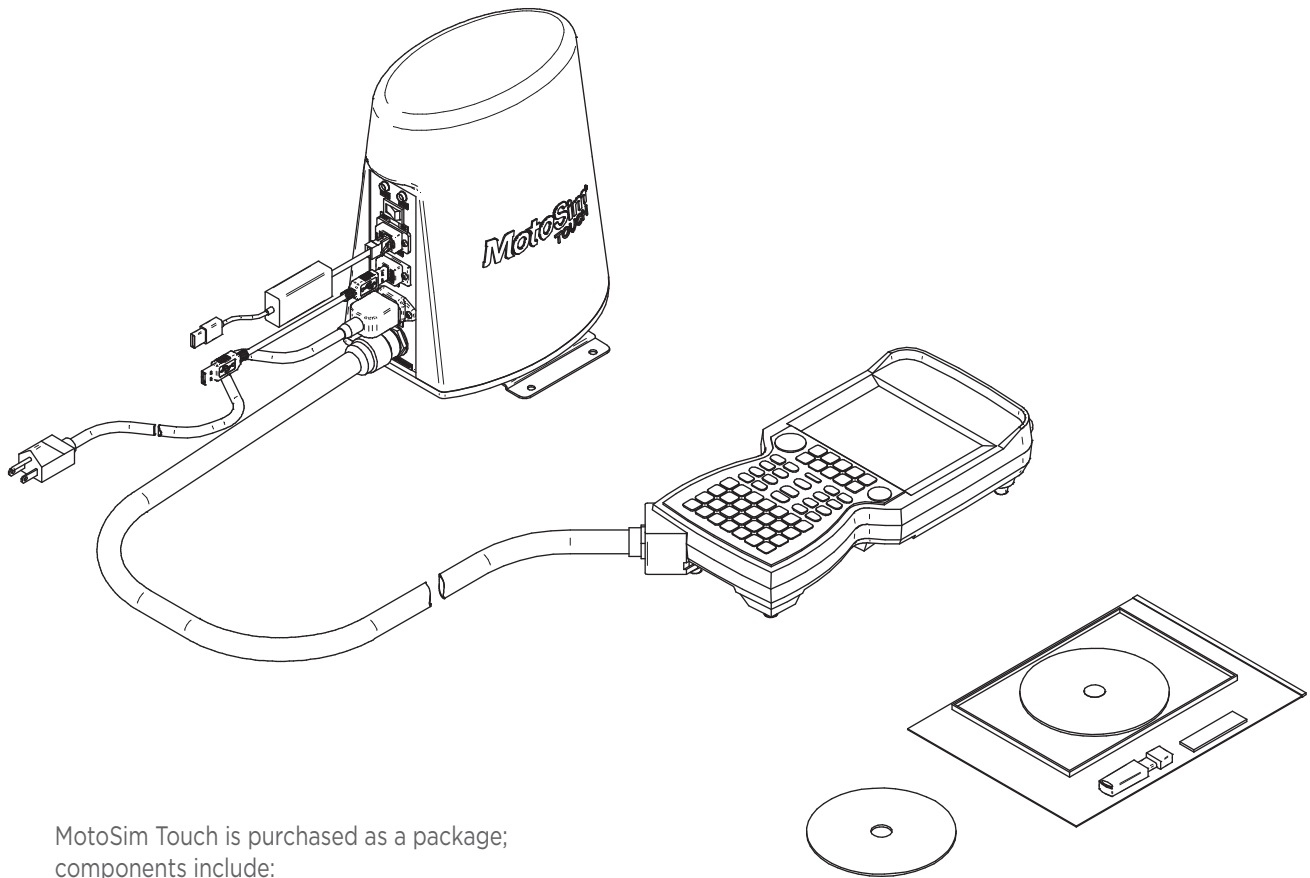

MotoSim Touch is purchased as a package;  
components include:

- MotoSim Touch (10 ¼" tall, 6 ¼" wide, 8 ¾" long)
- Programming pendant with 6-ft cable
- MotoSim EG-VRC for Education software
- Power, network and (2) USB interface cables



**1300 552 333**  
**www.ragroup.com.au**

**YASKAWA**

[motoman.com](http://motoman.com)