

# MOTOMAN MH215 II

Handling & General Applications  
with the MH-series



The 6-axis MOTOMAN MH215 II is a versatile, high speed robot offering superior performance for a variety of applications, like material handling, machine and press tending.

Despite of providing a high payload of 215 kg and the wide motion range of 2912 mm, the MOTOMAN MH215 II was designed with a width of 866 mm, therefore valuable floor space can be saved.

With the higher axis operation speed and speed reducer rigidity, a new vibration control system was developed. By reducing cycle times, this system realises high increases in productivity.

## KEY BENEFITS

- Fast, flexible and powerful
- High payload: 215 kg
- Wide motion range: 2912 mm
- Maximum performance using minimal floor space

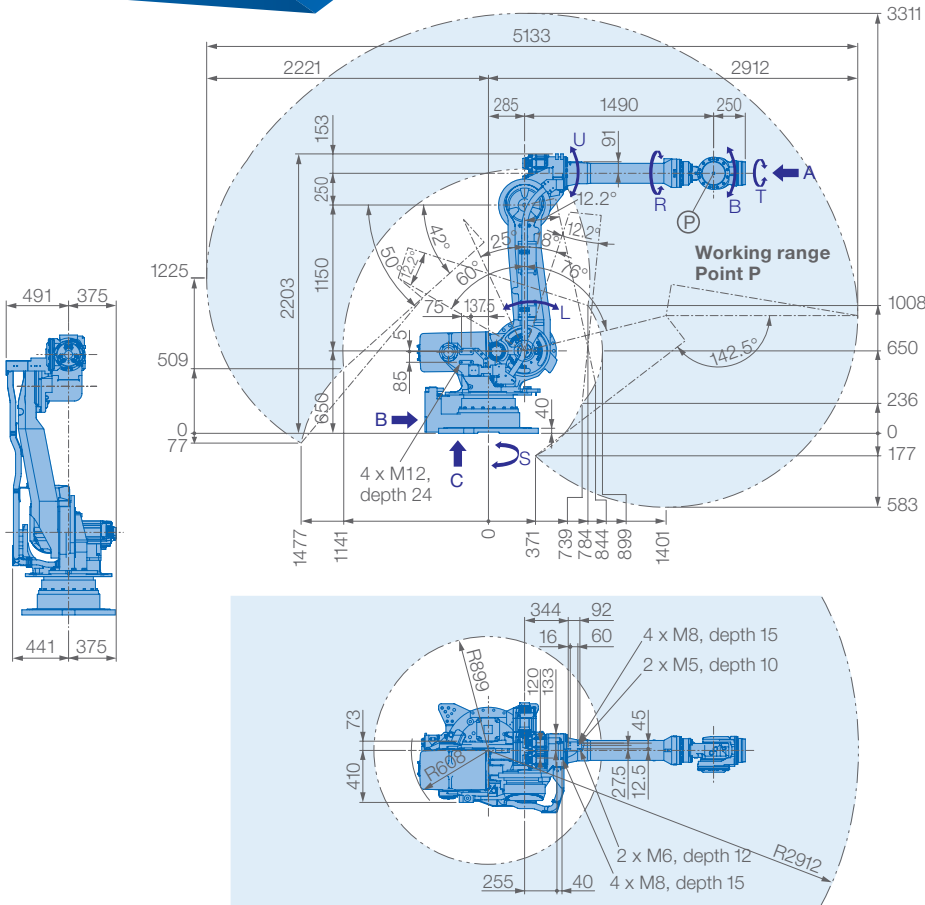

View A

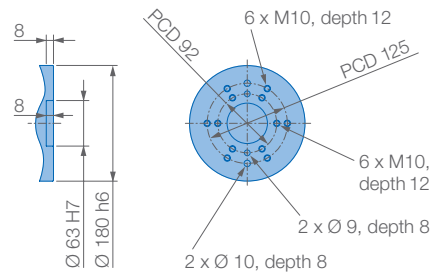

View B

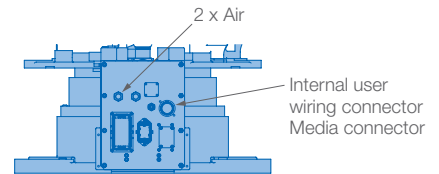

View C

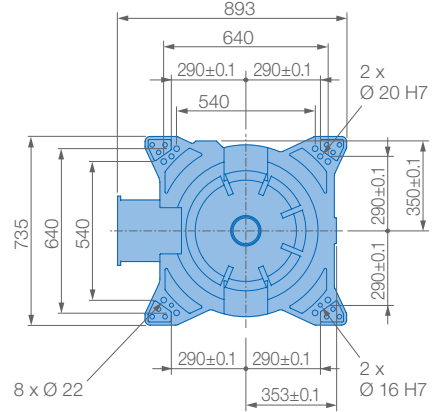

Mounting option: Floor  
Protection class: IP54/67

Allowable wrist load

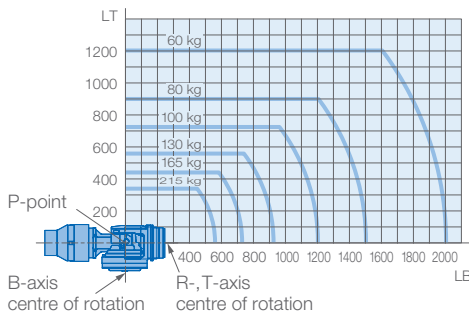

Specifications MH215 II					
Axes	Maximum motion range [°]	Maximum speed [°/sec.]	Allowable moment [Nm]	Allowable moment of inertia [kg · m <sup>2</sup> ]	Controlled axes
S	±180	100	-	-	6
L	+76/-60	90	-	-	Max. payload [kg]
U	+230/-142,5	97	-	-	Repeatability [mm]
R	±360	120	1176	317	Max. working range R [mm]
B	±125	120	1176	317	Temperature [°C]
T	±360	190	710	200	Humidity [%]
					Weight [kg]
					Power supply, average [KVA]